



## Metal seated gate valves in cast iron outside screw & yoke, PN 10



Art. 8-9

Flanges: UNI EN 1092-2 PN 10

Design: DIN 3352 Face to face length: EN 558-1, serie 14. DIN 3202 F4

Installation: horizontal/ vertical

APPLICATIONS • Fire fighting systems • Sugar factories • Industry

- Fig. 8: seats in brass

- Fig. 9: seats in stainless steel AISI 304

The metal seated gate valves in cast iron are a good solution for all those applications where it is necessary to check visually whether the valve is open or closed. Flat body, with outside screw and yoke, they are widely used in industrial plants. To be operated by handwheel.

### Materials

body - bonnet	cast iron GG25, EN-GJL-250
wedge	cast iron GG25, EN-GJL-250
handwheel	cast iron GG25, EN-GJL-250
stem	brass/stainless steelX20 CR13
sealing seats body & wedge	brass / st.st. 304
stem packing	graphited / o ring
bonnet gasket	asbestos free
painting	nitro enamel

## Dimensions

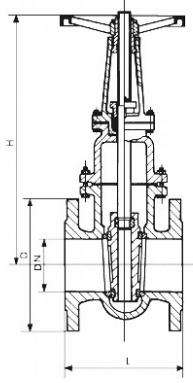

DN	L mm.	H mm.	D mm.	Weight kg.
40	140	265	150	14
50	150	275	165	18
65	170	335	185	23
80	180	355	200	30
100	190	400	220	36
125	200	495	250	53
150	210	585	285	64
200	230	700	340	102
250	250	830	395	141
300	270	960	445	187
350	290	1320	505	230
400	310	1470	565	342

## Pressure

DN	Nominal pressure		Test pressure Mpa		Max working pressure Mpa	
	mm	BAR	body	seat	120°C	150°C
40 - 400	10		1,5	1,1	0,8	0,5

