



Double ball automatic air valves, flanged PN 10, 16, 25, 40, 64



Art. 701-710

Flanges: UNI EN 1092-2 PN 10-16-25 - 40

Installation: at the high part of pipelines

APPLICATIONS • Aqueducts • Irrigation plants

- Fig. 701: flanges PN 10-16

- Fig. 710: flanges PN 25-40

- Fig. 711: flanges PN 64

Epoxy painting suitable for drinking water applications.

The double ball automatic air valves are used for applications related to troubles with air in the pipelines. Minimum pressure on seat: 0,3 bar. The double ball air valves have three functions:

- Discharge large amount of air during filling operations
- Discharge small amount of air during working operations
- Let air in during piping emptying operations

Materials

body	ductile iron GGG40/50, EN-GJS-400/500
cover	ductile iron GGG40/50, EN-GJS-400/500
floating balls	ABS / stainless steel
gasket	EPDM
painting	epoxy

Dimensions

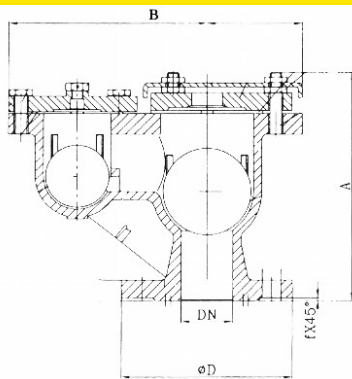

DN	A mm.	B mm.	D mm. PN 10/16/25	Weight kg.
50	290	290	150	14.5
65	290	330	165	15
80	290	36	185	19
100	360	335	200	26.5
150	490	535	285 / 300	58.5
200	570	560	340 / 360	125
250	450	520	405 / 425	130
300	490	520	460 / 485	160

Pressure

DN	Nominal pressure	Test pressure Mpa		Max working pressure Mpa
mm	BAR	body	seat	40°C
50-300	16	2,4	1,76	1,6
50-300	25	4,0	2,75	2,5

DN of pipeline

DN of air valve

< 200 mm	DN 50
200 mm - 250 mm	DN 80
300 mm - 500 mm	DN 100
600 mm - 900 mm	DN 150
1000 mm - 1200 mm	DN 200
> 1200 mm	DN 250 o 2 x DN 200

