



Cast steel short body gate valves outside screw and yoke, PN 16



Art. 60

Flanges: UNI EN 1092-2 PN 16

Design: DIN 3352 Face to face length: EN 558-1, serie 14. DIN 3202 F4

Installation: horizontal/ vertical

APPLICATIONS • Water • Steam • Oil and refineries

- Fig. 60A: body/wedge CF8/304

- Fig. 60I: body/wedge CF8M/316

The cast steel short body gate valves outside screw and yoke are used for several installations, usually for industrial plants with dangerous liquids, or high temperature, and they can carry pressure up to 16 bar. This gate valve is flanged PN 16. These gate valves are made in cast steel, with body and wedge seat rings in stainless steel. They come from standard execution by handwheel. Gear operated from DN 600 and up. Body, bonnet and wedge in stainless steel upon request.

**Materials**

|                              |                              |
|------------------------------|------------------------------|
| body-bonnet                  | cast steel GS-C25, GP-240-GH |
| wedge                        | cast steel GS-C25, GP-240-GH |
| handwheel                    | pressed steel                |
| stem                         | stainless steel X20 CR13     |
| sealing seats body and wedge | stainless steel              |
| stem packing                 | graphite                     |
| bonnet gasket                | graphite                     |
| painting                     | nitro enamel outside         |

## Dimensions

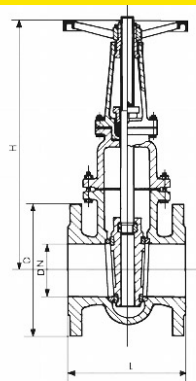

| DN  | L mm. | H mm. | D mm. | Weight kg. |
|-----|-------|-------|-------|------------|
| 50  | 150   | 315   | 165   | 17         |
| 65  | 170   | 370   | 185   | 19         |
| 80  | 180   | 410   | 200   | 21         |
| 100 | 190   | 450   | 220   | 27         |
| 125 | 200   | 525   | 250   | 35         |
| 150 | 210   | 600   | 285   | 56         |
| 200 | 230   | 760   | 340   | 63         |
| 250 | 250   | 990   | 405   | 98         |
| 300 | 270   | 1010  | 460   | 151        |
| 350 | 290   | 1140  | 520   | 186        |
| 400 | 310   | 1295  | 580   | 297        |
| 450 | 330   | 1380  | 640   | 460        |
| 500 | 350   | 1535  | 715   | 540        |
| 600 | 390   | 2435  | 840   | 930        |
| 700 | 430   | 2925  | 895   | 1200       |
| 800 | 470   | 3275  | 1015  | 1800       |
| 900 | 510   | 3670  | 1113  | 2800       |

## Pressure

| DN      | Nominal pressure | Test pressure Mpa | Max working pressure Mpa |
|---------|------------------|-------------------|--------------------------|
| mm      | BAR              | body              | seat                     |
| 50-600  | 16               | 2,4               | 17,6                     |
| 700-900 | 10               | 1,5               | 1,1                      |

