



## Cast steel cylindrical body gate valves non rising stem, PN 40



Art. 42

Flanges: UNI EN 1092-2 PN 40

Design: DIN 3352 Face to face length: DIN 3202 F15

Installation: horizontal/ vertical

APPLICATIONS • Water • Steam • Oil and refineries

Epoxy painting suitable for drinking water applications.

The cast steel cylindrical body gate valves non rising stem are used for several installations. This gate valve is flanged PN 40. These gate valves are made in cast steel, with body and wedge seat rings in stainless steel. They come from standard execution by handwheel.

### Materials

body-bonnet	cast steel GS-C25, GP-240-GH
wedge	cast steel GS-C25, GP-240-GH
handwheel	cast iron GG25, EN-GJL-250
stem	X20 CR13
sealing seats body and wedge	stainless steel
stem packing	graphited
painting	epoxy inside/outside

## Dimensions

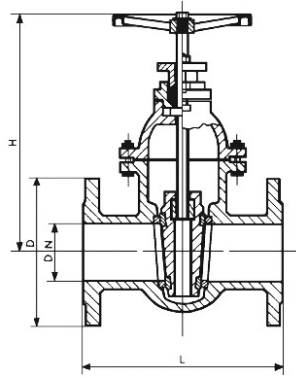

DN	L mm.	H mm.	D mm.	Weight kg.
40	240	280	150	19
50	250	325	165	22
65	270	365	185	28
80	280	415	200	38
100	330	455	235	55
125	360	505	270	79
150	390	555	300	100
200	460	745	375	206
250	530	865	450	334
300	630	945	515	380
350	690	1100	580	710

## Pressure

DN	Nominal pressure	Test pressure Mpa	Max working pressure Mpa
mm	BAR	body	seat
40-300	40	6,0	4,4
		150°C	400°C
		3,4	2,1

