



Cast steel cylindrical body gate valves outside screw and yoke, PN 40



Art. 2658

Flanges: UNI EN 1092-2 PN 40

Design: DIN 3352 Face to face length: EN 558-1, serie 26. DIN 3202 F7

Installation: horizontal/ vertical

APPLICATIONS • Water • Steam • Oil and refineries

The cast steel cylindrical body gate valves outside screw and yoke are used for several installations, usually for industrial plants with dangerous liquids, or high temperature, and they can carry pressure up to 40 bar. This gate valve is flanged PN 40. These gate valves are made in cast steel, with body and wedge seat rings in stainless steel. They come from standard execution by handwheel.

Materials

body-bonnet	cast steel GS-C25, GP-240-GH
wedge	cast steel GS-C25, GP-240-GH
handwheel	cast steel GS-C25, GP-240-GH
stem	stainless steel X20 CR13
sealing seats body and wedge	stainless steel
stem packing	graphite
bonnet gasket	graphite
painting	nitro enamel outside

## Dimensions

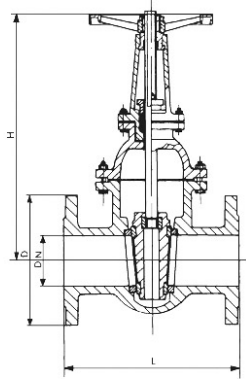

DN	L mm.	H mm.	D mm.	Weight kg.
40	240	418	150	26.5
50	250	426	165	30.5
65	290	520	185	40
80	310	555	200	53
100	350	644	235	66
125	400	746	270	103
150	450	855	300	146
200	550	1065	375	223
250	650	1270	450	383
300	750	1450	515	520
350	850	1695	580	857
400	950	1880	660	1087

## Pressure

DN	Nominal pressure	Test pressure Mpa	Max working pressure Mpa
mm	BAR	body	seat
40-400	40	6,0	4,4
		150°C	400°C
		3,42	2,31

