



Metal seated oval body gate valves in cast iron inside screw, PN 10 and 16



Art. 10-16

Design: DIN 3352 Face to face length: EN 558-1, serie 15. DIN 3202 F5

Installation: horizontal

APPLICATIONS • Water supply • Heating systems • Industry

- Fig. 10: flanges drilled UNI EN 1092-2 PN 10

- Fig. 16: flanges drilled UNI EN 1092-2 PN 16

The metal seated oval body gate valves in cast iron inside screw are the simplest kind of valve available on the market for water applications. With oval body, non rising stem, they are widely used. These gate valves have the same specifications as flat body type, but they can carry pressure up to 16 bar. They can be installed above or under the ground level. They come from standard execution by handwheel, you can apply for cap top and T key or reducing gear on demand. On request, production in ductile iron GGG50.

Materials

body - bonnet	cast iron GG25, EN-GJL-250
wedge	cast iron GG25, EN-GJL-250
handwheel	cast iron GG25, EN-GJL-250
stem	brass/ stainless steel X20 CR13
sealing seats body & wedge	brass
stem packing	graphited / o ring
bonnet gasket	asbestos free
painting	nitro enamel

## Dimensions

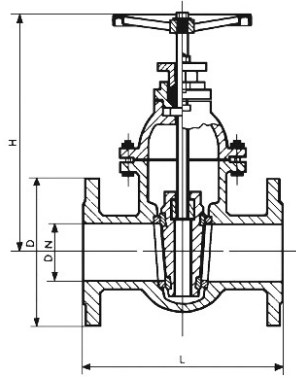

DN	L mm.	H mm.	D mm.	Weight kg.
40	240	255	150	13
50	250	263	165	20
65	270	287	185	20
80	280	310	200	31
100	300	358	220	34
125	325	400	250	60
150	350	430	285	77
200	400	598	340	95
250	450	675	395/405	139
300	500	755	445/460	252
350	550	890	505/520	305
400	600	1000	565/580	400
500	700	1200	670/715	700
600	800	1360	780/840	950

## Pressure

DN	Nominal pressure	Test pressure Mpa	Max working pressure Mpa
mm	BAR	body	seat
120°C	150°C		
40-600 fig 10	10	1,5	1,1
40-600 fig 16	16	2,4	17,6
		1,4	0,8

